

EXECUTIVE / LONG GUN SAFE



Read this manual carefully and never store it inside the safe!

EXECUTIVE / LONG GUN SAFE

PACKAGE CONTENTS

- 1 – Executive / Long Gun Safe
- 1 – Operation Manual
- 2 – Override Access Keys
- 2 – Storage-Box Keys
- 4 – “AA” Batteries
- 1 – Mounting Kit w/ Bolts

ATTENTION

DO NOT RETURN SAFE TO STORE!

For missing parts or difficulty operating your safe, please contact our Consumer Assistance Department by telephone.

Store will not accept returned products without prior authorization. You must first contact our consumer assistance department.

US/Canada 1-877-354-5457 (Toll Free)

Mexico 01-800-288-2872 After English voice recording stops you must then enter 800-860-1677 to complete your call. (Toll Free)

Australia 0011-800-5325-7000 (Toll Free)

Germany/New Zealand 00-800-5325-7000 (Toll Free)

Other Countries XX*-310-323-5722

XX*- Dial U.S. Country Code first (Toll Charges Apply)

DIGITAL LOCK OVERVIEW

- | | |
|------------------------|-------------------------|
| A - Lock Knob | F - Entry Lever Handle |
| B - Override Key Cover | G - Reset Button |
| C - Green LED | H - Battery Compartment |
| D - Red LED | |
| E - Yellow LED | |

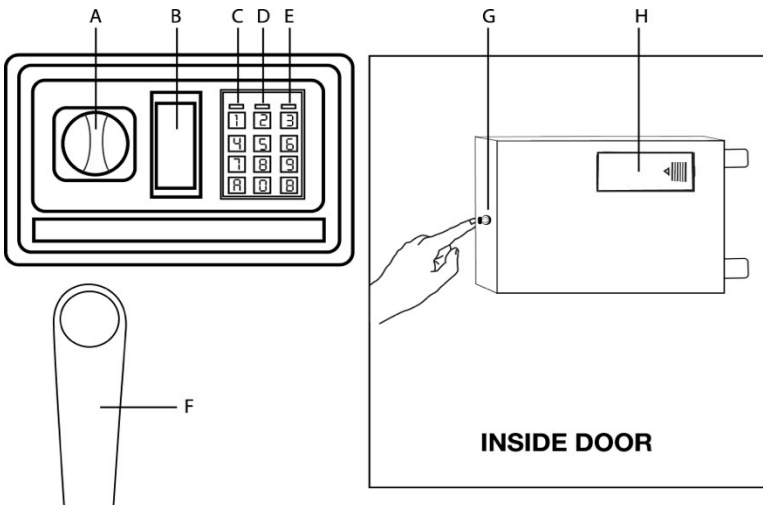

SETUP

STEP 1. OPEN SAFE WITH OVERRIDE KEY

1. Remove override key cover with small screwdriver.
2. Insert override key and turn left to unlock safe.
3. Turn knob to right (clockwise) and unlock safe
4. Turn lever to right (counter clockwise) to disengage the bolts and open door.

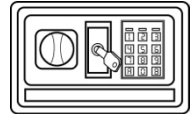

STEP 2. INSTALL BATTERIES

1. Remove battery compartment (A) cover on inside door. Insert 4 "AA" batteries (included). Ensure the batteries are installed in the correct direction, with regard to polarity (+ and -).
2. Replace the battery cover.
3. Do not close door before testing digital lock.

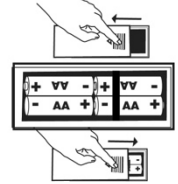

STEP 3. TEST DIGITAL LOCK

1. With door open, turn knob left to put locking door bolts in lock position.
2. Remove override key and store in a secure place.
NEVER STORE KEYS INSIDE SAFE!
3. Enter the preset pass code: "1"- "5"- "9"- "B".
4. Turn knob to right within 5 seconds.
5. Lock bolts should recede into the unlocked position.

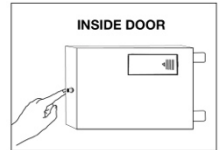

STEP 4. PROGRAM A NEW PASSCODE

1. With door open, press reset button (C) inside door.
2. Yellow light is on, enter new pass code in 30 seconds.
3. Enter new code (3 to 8 digits) followed by "A" or "B".
4. Safe will beep and yellow light will turn off. Lock bolts should recede into the unlocked position.

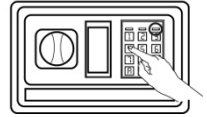

NOTE: The factory pre-set code will not work after a new pass code is programmed.

OPERATION

TO OPEN THE SAFE

1. To unlock and open safe, enter the pass code followed by "A" or "B".
2. Turn knob to right (clockwise) and unlock safe.
3. Turn lever to right (counter clockwise) to disengage the bolts and open.

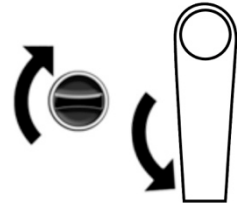

TO CLOSE THE SAFE

1. Close the door and hold it in the closed position.
2. Turn lever to left (clockwise) to engage the bolts and secure door.
3. Turn knob to the left (counter clockwise) and lock safe.



SECURE LOCKOUT PERIODS

If a wrong code is entered three times in a row, the digital keypad will begin a 20 second secure lockout period. During this secure lockout period the keypad will become disabled.

If a wrong code is entered three more times in a row, the digital keypad will begin another 20 second secure lockout period.

If a wrong code is entered three times in a row for a third time, the digital keypad will begin a 5 minute secure lockout period.

Once the lockout period has expired, the safe can be unlocked using the correct pass code.

You may use the override key to open safe, but keypad will complete the full lockout period.

OVERRIDE ACCESS KEY

If the pass code is unavailable or your keypad fails due to dead batteries or other malfunction, you can open the safe using the override access key (see STEP 1. in the SETUP section).

REPLACING BATTERIES

NOTE: The pass code will not be erased if the batteries become weak or are removed.

Weak or dead batteries should be replaced immediately and all 4 batteries should be changed. To replace the batteries please follow the instructions in STEP 2. in the "SETUP" section. Remember to always remove batteries from safe if not using for an extended period of time. If your batteries are completely dead and you cannot open the safe by using the digital keypad, use the override access key to open safe and access the battery compartment.

NOTE: It is NOT RECOMMENDED to use Non-alkaline or rechargeable batteries.

IF YOU FORGET THE PASSCODE

1. Use the override access key to open safe.
2. With door open, press red reset button inside door.
3. Yellow light is on; enter new pass code in 30 seconds.
4. Enter pass code (3 to 8 digits) followed by "A" or "B".
5. Safe will beep and yellow light will turn off.

ORDERING ADDITIONAL SAFE / STORAGE BOX KEYS

The following information is required to order keys for either the safe or the locking storage box:

1. PROOF OF OWNERSHIP (1 of 2 Options Below)

SALES RECEIPT & IDENTIFICATION – INTERNATIONAL ORDERS ONLY!

- Copy of sales receipt showing Store, Date & Product Description.
- Copy of your picture I.D. (Drivers license, passport, regular I.D.).

PRODUCT OWNERSHIP VERIFICATION FORM

If sales receipt is not available, contact us by email or telephone to request a “Product Ownership Verification Form”.

2. ORDER INFORMATION

CONTACT INFORMATION

- Name & Shipping Address
- E-mail address (If Available)
- Telephone Number
- Best Time to Contact You

PRODUCT INFORMATION

- Safe Model #
- Safe Serial #
- Lock Key #
- Quantity of Keys Ordered

3. METHOD OF PAYMENT

- Telephone:
Visa or MasterCard
- Mail:
Check or Money Order

NOTE: For pricing please contact Consumer Assistance.
Contact information is located on the back cover of this manual

Terms subject to change without prior notification.

LOCATING SAFE IDENTIFICATION NUMBERS

SERIAL NUMBER

Located on lower right corner on front of safe.
Do Not Remove Safe I.D. Tags!



KEY NUMBER

4 Digit Number etched on the metal collar
located around the key hole.

NOTE: The number on the metal collar of the
safe key hole is different from the number that
is on the storage box lock. Be sure to indicate
the correct number of key needed when
ordering.



LOCKING STORAGE BOX

This safe includes a built-in storage-box. It can be used to place accessories, hand guns, ammo and many other personal items.

To open:

Insert supplied key and turn fully to the right and pull door open.

To close:

Push door to closed position, turn key fully to the left until it stops. The door is now in the locked position. Remove key and store in a safe place.

Note: If storage box replacement keys are needed please refer to page 4 of this manual. You will need the key number which is a 4 digit number etched on the metal collar located around the key hole.



MOUNTING KIT

You may bolt your safe to the wall or floor to added theft protection and resistance to tipping.

Your safe has pre-drilled bolt-down holes in the back panel and in the floor.

To secure your safe to the wall and/or floor:

1. Select a suitable and convenient location for your safe.
2. Empty the safe and remove the carpet.
3. Locate the predrilled holes on the inside of safe.
4. Place your safe in the desired location.
5. Line up the predrilled holes and mark the floor or wall through the holes.
NOTE: It is not recommended to attempt to bolt to both floor and wall.
6. Move the safe aside to clear marked spots for drilling.
7. Drill holes appropriate for hardware being used and the mounting surface. INCLUDED: (2 each – bolts, washers and masonry anchors).
8. Place the safe back over the holes and install the fasteners as required.
9. Once completed, replace the carpet.

NOTE: Bolting/unbolting of the unit is at the consumer's expense and discretion. LH Licensed Products is not responsible for any costs incurred if the unit is to be replaced.

If you have any questions about mounting the safe, please check with your local home center/hardware retailer or independent contractor.

LIMITED WARRANTY

LH Licensed Products, Inc., (“LHLP, Inc.”) warrants that for a period of seven (7) years from the date of purchase, this product will be free from structural or mechanical defects resulting from materials or workmanship. LHLP, Inc., at its sole option and as the purchaser’s sole remedy under this warranty, will repair or replace this product or any component of the product found to be defective during the warranty period. Replacement or repair will be made with a new or remanufactured product or component. If the product is no longer available, replacement may be made with a similar product of equal or greater value.

THIS IS YOUR EXCLUSIVE WARRANTY.

Our goods come with guarantees that cannot be excluded under the Australian Consumer Law. You are entitled to a replacement or refund for a major failure and for compensation for any other reasonably foreseeable loss or damage. You are also entitled to have the goods repaired or replaced if the goods fail to be of acceptable quality and the failure does not amount to a major failure.

This warranty is only valid for the original retail purchaser from the date of initial retail purchase and is not transferable. You must keep the original sales receipt. Proof of purchase is required to obtain warranty service.

LHLP, Inc. dealers, service centers, or retail stores selling this product do not have the right to alter, modify or in any way change the terms and conditions of this warranty.

This warranty does not apply to the finish on the product. This warranty does not cover normal wear and tear of parts or damage resulting from any of the following: negligent use or misuse of the product, use contrary to the operating instructions, disassembly, repair or alteration by anyone other than LHLP, Inc. or an authorized service center, improper installation, or exposure to extremes of heat or humidity. Further, the warranty does not cover Acts of God, such as fire, flood, hurricanes and tornadoes.

LHLP, Inc. shall not be liable for any incidental or consequential damages caused by the breach of any express or implied warranty or otherwise relating to the sale of this product. LHLP, Inc. is also not responsible for: costs associated with removing or installing the product; damage or loss of the contents of the product; nor for the unauthorized removal of the contents; or damages incurred during shipment.

THE ABOVE WARRANTY IS IN LIEU OF ALL OTHER WARRANTIES, EXPRESS OR IMPLIED, INCLUDING ANY WARRANTIES OF MERCHANTABILITY OR FITNESS FOR A PARTICULAR PURPOSE, AND LHLP, INC. DISCLAIMS ANY AND ALL OTHER COVENANTS AND WARRANTIES.

Except to the extent prohibited by applicable law, any implied warranty of merchantability or fitness for a particular purpose is limited in duration to the duration of the above warranty period. Some states, provinces or jurisdictions do not allow the exclusion or limitation of incidental or consequential damages or limitations on how long an implied warranty lasts, so the above limitations or exclusion may not apply to you. This warranty gives you specific legal rights, and you may also have other rights that vary from state to state, or province to province, or jurisdiction to jurisdiction.

CONSUMER ASSISTANCE

EMAIL (Best Contact Method): LHLPCustomerService@LHLPinc.com

WEBSITE: www.Honeywellsafes.com

ADDRESS: Consumer Assistance Dept.
LH Licensed Products, Inc.
860 East Sandhill Avenue
Carson, CA 90746 USA

TELEPHONE: **US/Canada** 1-877-354-5457 (Toll Free)
Mexico 01-800-288-2872 After English voice recording stops you must then enter 800-860-1677 to complete your call. (Toll Free)
Australia 0011-800-5325-7000 (Toll Free)
Germany/New Zealand 00-800-5325-7000 (Toll Free)

Other Countries XX*-310-323-5722 (Toll Charges Apply)
XX*- Dial U.S. Country Code first

CALL CENTER HOURS: **US/Canada** 7am – 5pm (PST**) Mon – Fri

CALL BACK HOURS: **Other Countries** 7am – 8pm (PST**) Mon – Fri
PST**- Local time in Los Angeles, CA, USA

INTERNATIONAL CALL BACK HOURS:

If you need to speak with a consumer assistant and cannot contact us during the Call Center hours above, please send an email or leave a telephone message, including your Name, Telephone Number and the best time for us to contact you during the Call Back hours above and we will make our best effort to contact you and help to answer any of your questions or concerns.

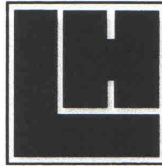

Manufactured by
LH Licensed Products, Inc.
860 East Sandhill Avenue
Carson, CA 90746

The Honeywell Trademark is used under license from Honeywell International Inc. Honeywell International Inc. makes no representations or warranties with respect to this product.